

ABS Corner Shelf

PA155941

Fixing Pack Contents / Tools Required

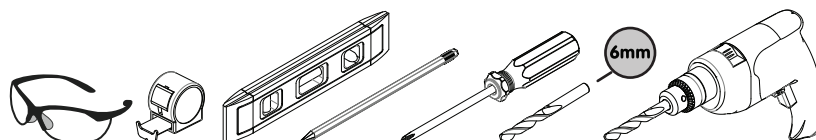
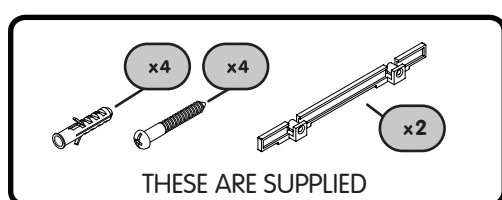

Please follow these fixing and care instructions to ensure that your product is fitted safely and that it retains its high quality finish. Please retain this leaflet for future reference.

KEEP DIY TOOLS OUT OF THE REACH OF CHILDREN

Home Safety Advice

Always take care when using power tools, particularly in the bathroom.

Always check for hidden cables and pipework before drilling and take extreme care if there is any water in the working area.

It is advisable to use a residual current circuit breaker (RCCB).

Always wear suitable eye protection when drilling.

If the product is to be fitted on a ceramic tiled wall, a ceramic drill bit should be used.

Always ensure that the drill hole passes through the central tiled area rather than through the grouted area. To prevent damage to the tile, mask the area around the hole with tape before drilling.

Do not strike the product with hard or sharp objects.

Do not position glass components in close contact with a heat source .

Product Care

To retain the best quality finish, clean product regularly with a soft damp cloth.

Do not use abrasive or chemical cleaners, as these will damage the product.

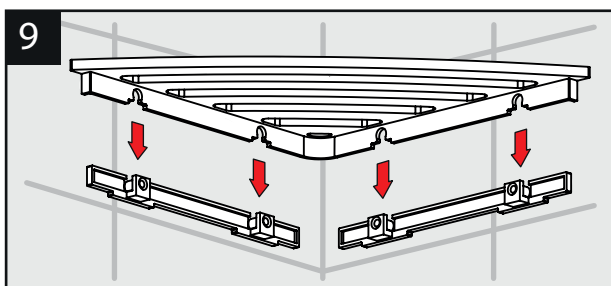
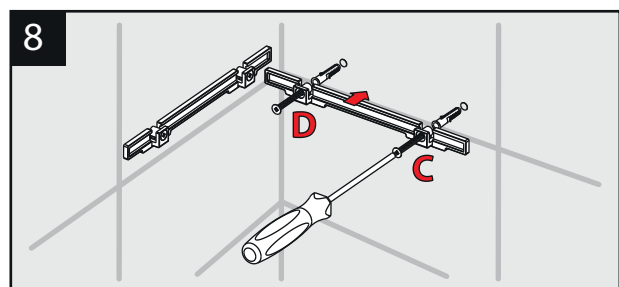
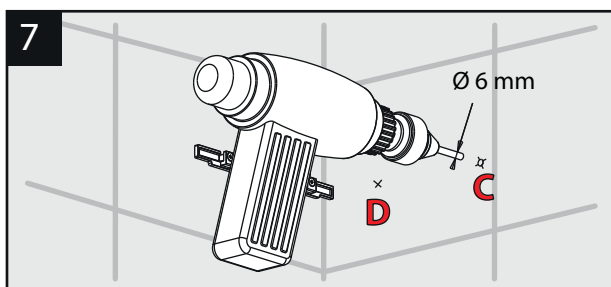
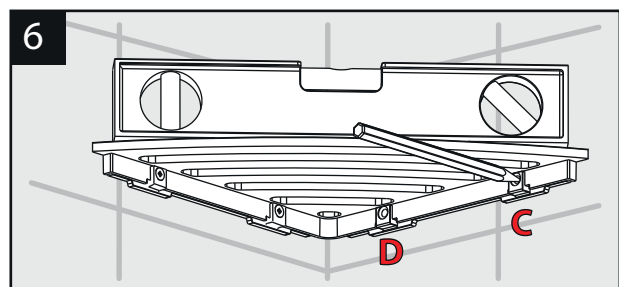
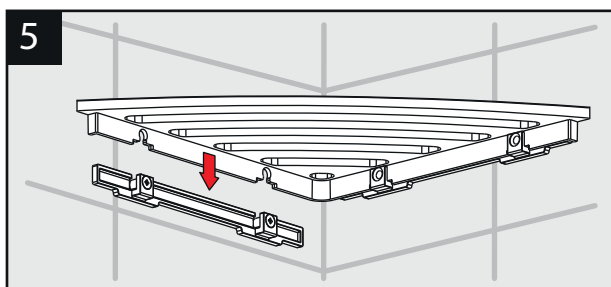
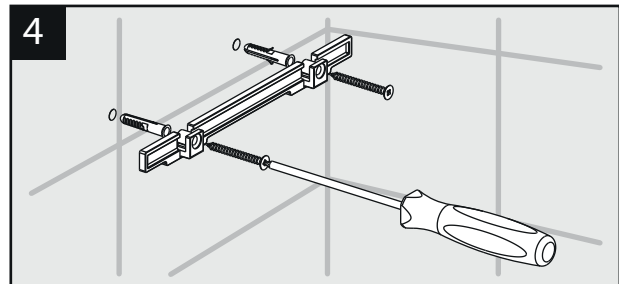
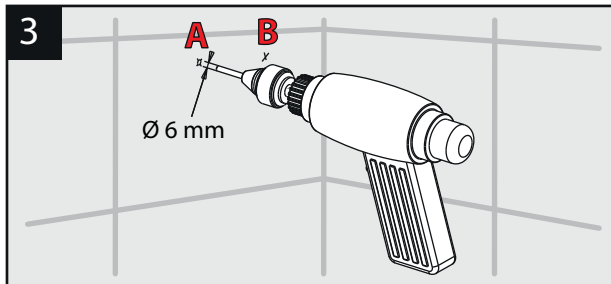
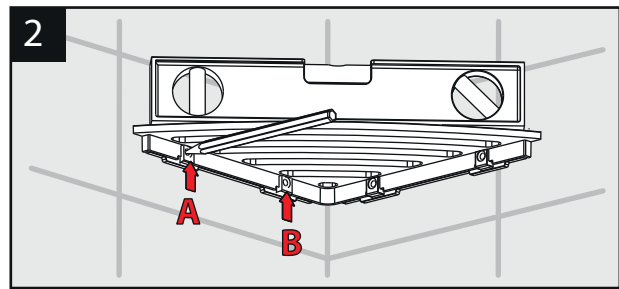
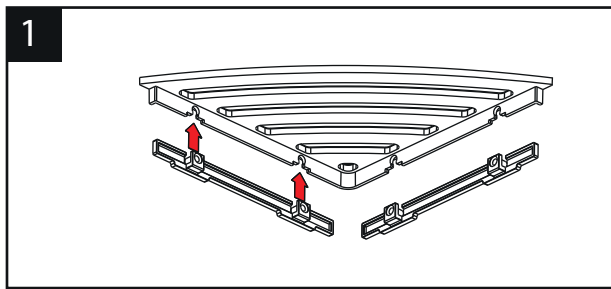

Croydex,
 Central Way, Andover, Hants, SP10 5AW, UK
 Tel: +44 (0) 1264 365881
 Fax: +44 (0) 1264 356437
 Website: www.croydex.com
 Email: info@croydex.co.uk